

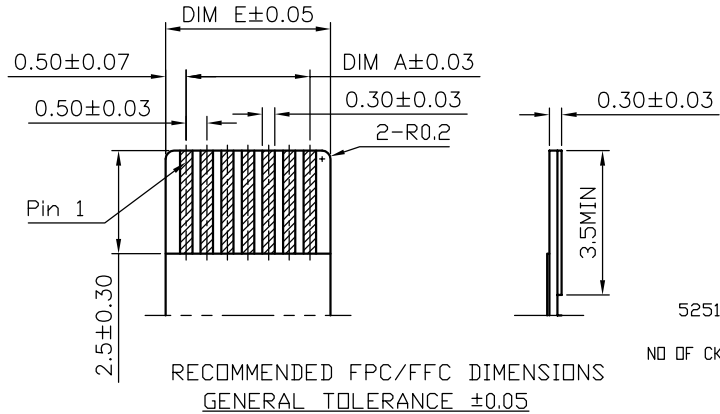

A B C D E F

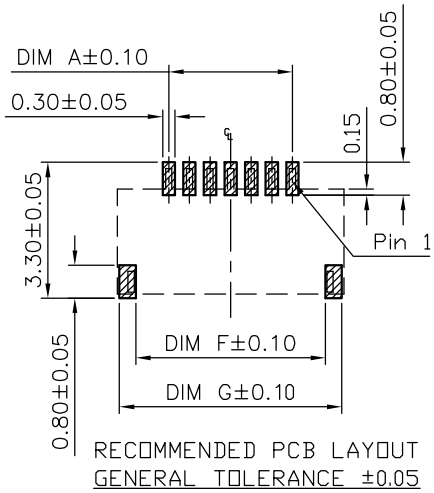

- NOTES:
- MATERIAL:
    - HOUSING: THERMOPLASTIC, HIGH TEMP., UL94V-0;
    - ACTUATOR: THERMOPLASTIC, HIGH TEMP., UL94V-0;
    - CONTACT: COPPER ALLOY
    - FITTING NAIL: COPPER ALLOY
  - FINISH:
    - CONTACT: 50μ" MIN. NICKEL UNDERPLATING OVERALL. 1: GOLD FLASH PLATING.
    - FITTING NAIL: 50μ" MIN. NICKEL UNDERPLATING OVERALL. 80μ" MIN. MATT TIN PLATING (LEAD FREE).
  - REFLOW SOLDER CAPABLE TO 260°C PER ACES SPEC.
  - SPEC. PLS. REFER TO PS-52515-XXXXX-XXX
  - PACKAGE PLS REFER TO PS-91506-XXXXX-XX-TRP
  - PART NUMBER

52515-XXX X X-VXX

XXX	HOUSING COLOR	ACTUATOR COLOR	PACKAGE
001	BLACK	NATURAL	91506-XXXCR

PLATING  
1: GOLD FLASH

PACKING  
0: TAPE & REEL  
4: TAPE & REEL WITH MYLAR

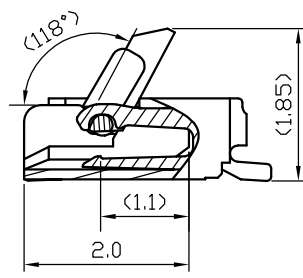
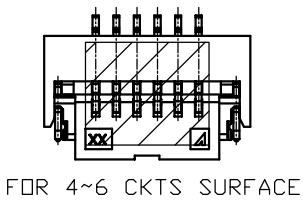
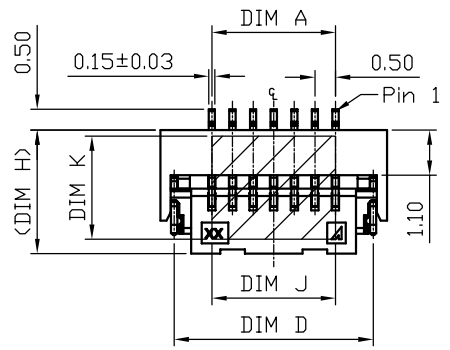

ACTUATOR OPEN STATE  
(SCALE 6:1)

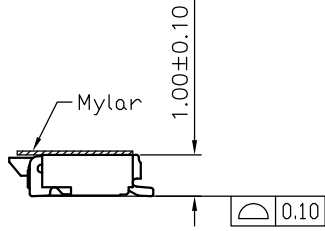
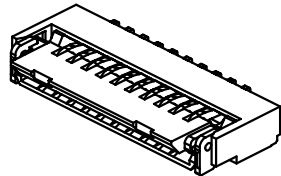
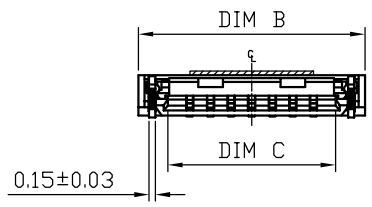

CKT	DIM A	DIM B	DIM C	DIM D	DIM E	DIM F	DIM G	DIM H	DIM J	DIM K
006	2.50	5.0	3.57	4.33	3.50	4.10	4.90	3.0	3.0	2.5
008	3.50	6.0	4.57	5.33	4.50	5.10	5.90	3.0	3.0	2.5

QUALITY SYMBOLS MAJOR Ⓢ CRITICAL Ⓢ	DRAWN BY Zhu, Wei DATE 22/02/15	
GENERAL TOLERANCES (UNLESS SPECIFIED) .X ±0.5 .XX ±0.15 .XXX ±0.1 ANGLES ±2°	CHECKED BY Xu, Zhi Yong DATE 22/02/15	
	APPROVED BY Xu, Zhi Yong DATE 22/02/15	TITLE 0.5 PITCH EASY ON FFC/FPC CONN. SMT R/A B/C TYPE
	UNITS mm	SIZE A4
	SCALE 6:1	DWG NO. 52515-XXXXX-XXX
	SHEET NO. 1 OF 1	REV B
		PART NO. SEE NOTES